

Sustainable Flow-switch Testing



Zonecheck®

Zonecheck is an efficient and simple way to carry out routine flow-switch testing, saving 100% of the water normally discharged to waste.

A simple and sustainable solution for performing flow-switch tests.

Zonecheck is the modern way to carry out flow-switch testing quickly, efficiently and inexpensively, saving 100% of the water normally discharged to waste.

Conventionally routine testing is carried out by opening a drain valve (which is often hard to locate) and discharging water the sprinkler zone, causing a drop in the pressure. This causes water to flow along the pipe past the flow-switch paddle which, after a sustained flow, triggers an alarm.

HOW IT WORKS

Zonecheck simplifies testing by re-circulating the water within the pipe around the flow switch, to simulate the flow of one sprinkler head in operation, regardless of where the Zonecheck is installed or located on the system. Zonecheck is simple and easy to use, requiring no specialist skills. Zonecheck does not initiate the fire pump which eases co-ordination and labor whilst also reducing the risk of false alarms.

SUSTAINABILITY

With Zonecheck there is no unnecessary discharge of water. Typically with 4 tests required per annum, Zonecheck saves 330 gallons of water per annum for each flow-switch that is installed (for a building with 50 flow-switches, Zonecheck can save 16,500 gallons annually). Pipe corrosion is also reduced as no fresh oxygenated water is introduced into the system.

**WITH ZONECHECK
THERE IS NO
UNNECESSARY
DISCHARGE OF
WATER.**

System Benefits

OPEX SAVINGS

Keep operational costs down with Zonecheck's efficient method of routine testing and reduced facilities management.

REMOTE TESTING

Testing can be carried out from a convenient location via the key-switch.

QUICK & EASY TESTING

As no water is discharged, there's no need to locate and open drain valves. Testing is easy, takes less time and requires no specialist skills.

SUSTAINABLE

Saves water, energy and labor reducing the carbon footprint of managing a sprinkler system.

CODE COMPLIANT

Zonecheck performs the required flow-switch test under NFPA 13 in a compliant fashion and is approved as a testing device by FM and UL.

EFFICIENT

Simply turn the key-switch to carry out a compliant test, no fire pumps are run and requires no additional labor.

Testing via water discharge causes the fire pumps to operate which then have to be manually switched off after each test, meaning that two engineers are required. Zonecheck creates a closed loop test circuit so that the operation of fire pumps is not required. Zonecheck saves water, saves electricity/diesel, saves time, saves labor and increases the systems life; all of which means a more sustainable system and a substantial reduction in the carbon footprint of maintaining a sprinkler system.

TRADITIONAL TESTING METHODS ARE DIFFICULT, LABOR INTENSIVE AND COSTLY, REQUIRING SPRINKLER ENGINEERS. ZONECHECK CAN DO ALL THIS REMOTELY WITH A TURN OF A KEY.

ZONECHECK ADDRESSABLE

In response to the ever-increasing size and complexities of modern buildings, coupled with demand for more effective building management, Project Fire has developed Zonecheck Addressable for fully automated routine testing and sprinkler system monitoring. For more information contact one of our representatives for a brochure or visit www.projectfire.co.uk

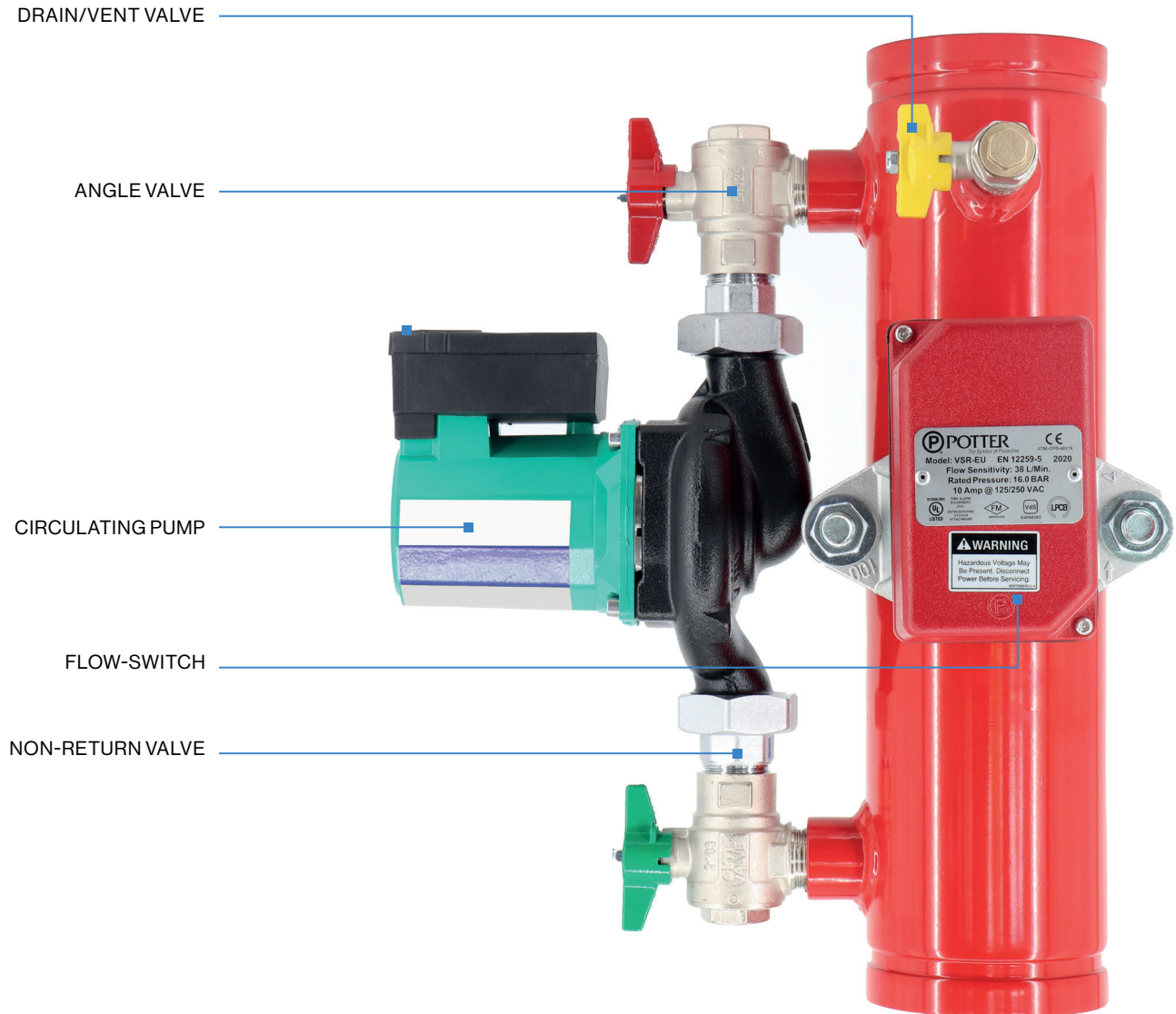

APPROVALS

Zonecheck is approved by for worldwide use including FM, UL, LPCB and VdS in addition to other national approval bodies to provide compliant flow-switch testing.

Zonecheck environmental claims have been validated by UL Environment and is listed on their SPOT 'sustainable product database'.



Product Configurations

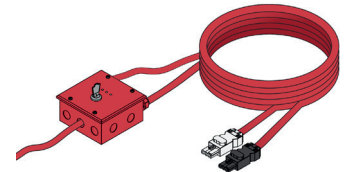
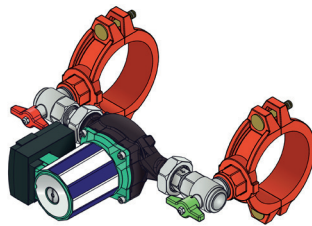
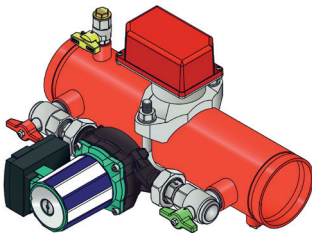

ZONECHECK

Automatic flow-switch tester, circulates water around the flow-switch so there is no need to discharge water.

ZONECHECK RETRO-FIT/LIVE

Zonecheck Retro-fit is designed to fit around an existing flow-switch. Zonecheck Live can also be installed around an existing flow-switch without the need to drain the system.

KEY-SWITCH

Each Zonecheck comes with it's own key-switch, turning the key-switch activates the Zonecheck pump. Several key-switches can be wired together for remote group testing.

PRE-WIRED LOOM

A factory wired and tested Zonecheck for easier site installation and reduced installation costs, no electrician is required for commissioning.

*see Zonecheck Addressable for automated testing.

**WANT TO KNOW MORE ABOUT SIMPLIFYING YOUR TESTING ROUTINE?
CONTACT A MEMBER OF OUR TEAM.**



Steven Brown & Associates, Inc.
Fire Pump Sales & Service

Designated United States Distributor

Toll-Free: 866-248-1076

Cell: 860-883-0213

zonecheck@stevenbrownassociates.com